

STONE

FENCE + FURNITURE



INSTALLATION INSTRUCTIONS

WWW.STONEFENCING.CA

Profile _____

Boards/Panel _____

FENCE COMPONENTS

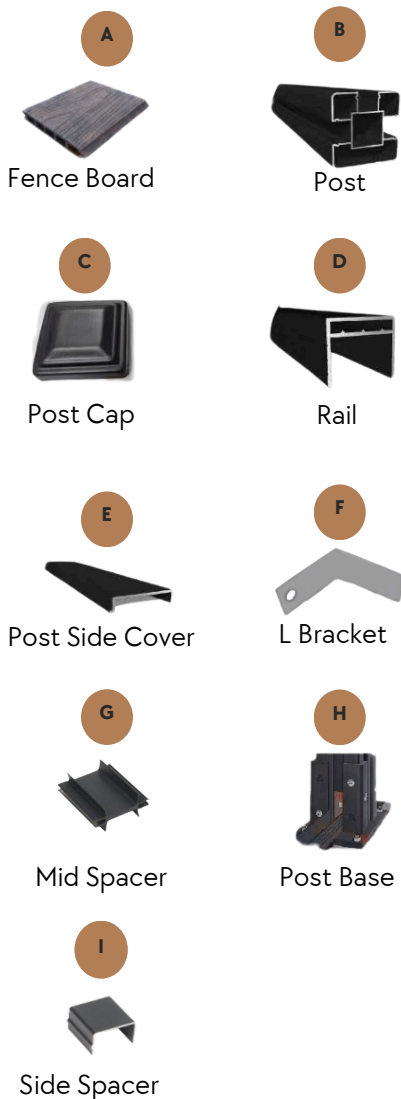

TOOLS

- Pencil
- Drill
- Impact
- Hammer
- Post Level
- Saw
- 3/8" Concrete Drill Bit
- 9/16" Socket Wrench
- Hammer Drill
- 6" Phillips Bit
- String Line
- Mallet

*other tools and supplies may be needed other than what is listed



SUPPLIES

- Quick Set Concrete (in ground installation only)



HARDWARE

- Provided:
- Concrete Anchor Bolts
 - Self Tapping Screws

STEP 1

ASSEMBLE TOP AND BOTTOM RAILS

Parts

4 L Brackets
2 Rails

Tools

Hammer

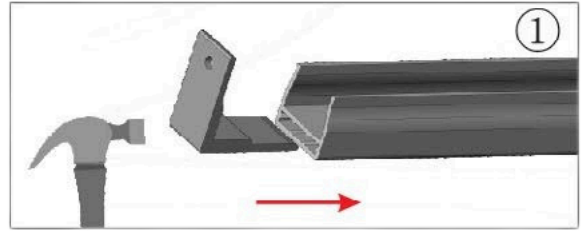

Bottom Rail

With the rail (D) facing up, firmly tap two L-brackets (F) into the channel of the rail on either end until the rail channel is flush with the lip of the bracket. Ensure hole pointed up.

Top Rail

With the rail facing down, firmly tap two L-brackets into the channel of the rail on either end until the rail is flush with the lip of the bracket. Ensure hole pointed up. If supplied, use the foam brackets for top rail.

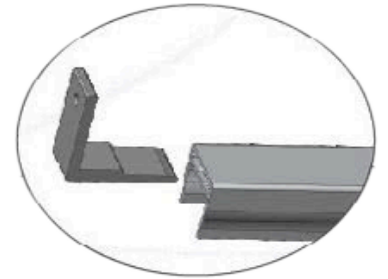

**You can repeat for all panel sections and rails now or later*

STEP 2A

IN GROUND POST INSTALLATION

Parts

2 Posts
4 Self Tapping
Screws

Tools

Measuring tape
Shovel
Post Level
Drill
6" Phillips Bit

Supplies

Quick set Concrete



If installing a gate with a 3x3 post, ensure the flat surface of the post (without a channel) is placed on one side where the hinge will mount.

STEP 2A

Continued

Mark Post Locations

- Measure and mark the location of each post at 71" on center — meaning the center of one post to the center of the next should be exactly 71".

Dig Post Holes

- Dig holes approximately 24" to 30" deep at each marked location.
- Double-check your measurements to ensure the spacing remains 71" on center.

Set Posts in Place

- Insert one post (B) into each hole.
- Ensure the open sides of the posts are facing the correct direction to accept the rails.

Install Bottom Rail

- Slide the bottom rail (from Step 1) into the channels of the two adjacent posts.
- Using a 6" bit, attach L-bracket to the inside of the post channel using only the provided self-tapping screw. Do not overspin.
- The bottom rail should be installed 2.5" to 3.5" above the ground. This clearance helps prevent damage from seasonal ground movement.

Optional: Install Top Rail

- Using a top rail, repeat the process above and install 12" down from the top of the post.

Ensure Posts Are Level

- Use a post level to make sure each post is plumb (straight up and down) and square before securing.

Set Posts in Concrete

- Mix and pour concrete into each hole to secure the posts in place. Allow concrete to cure before attaching boards or panels.
- If needed, trim posts to the correct height after installation.

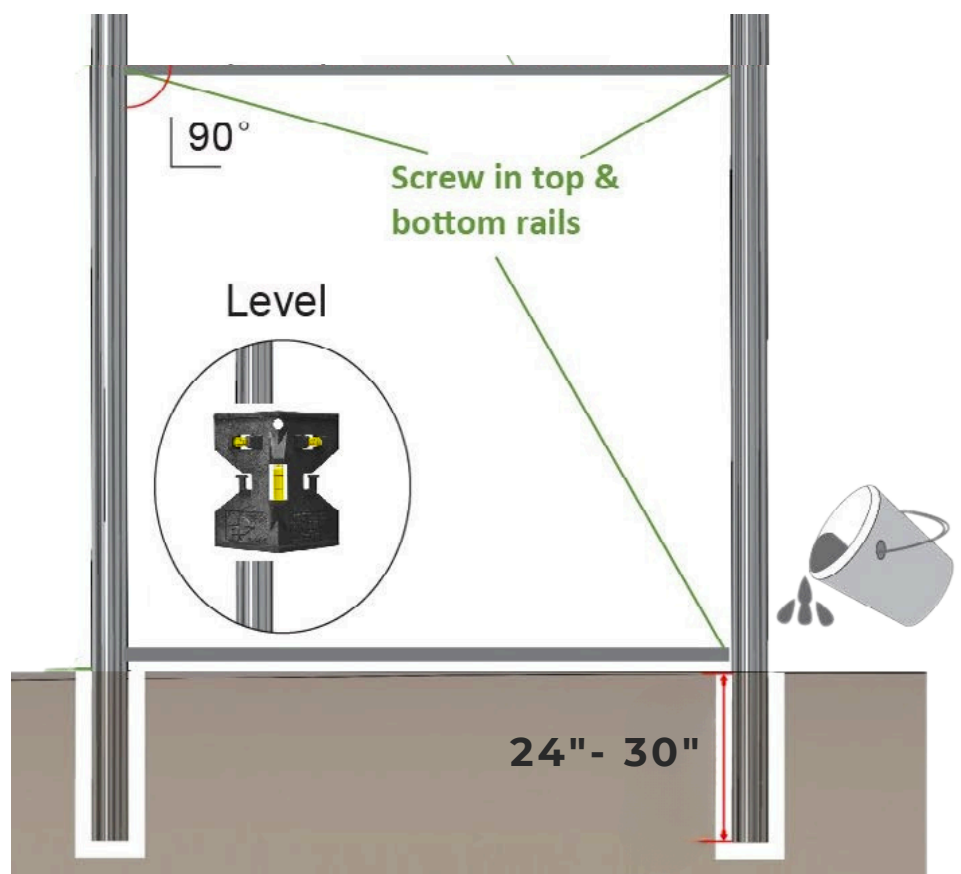

DO NOT OVERSPIN SCREWS. Use an impact on setting #2.

STEP 2B

POST BASE POST INSTALLATION

Parts

- 2 Posts
- 8 Anchor Bolts
- 2 Post Bases
- 24 Attach Screws

Tools

- Measuring tape
- Post Level
- Hammer Drill
- Impact
- 3/8" Concrete Drill Bit
- 9/16" Socket
- 6" Phillips Bit

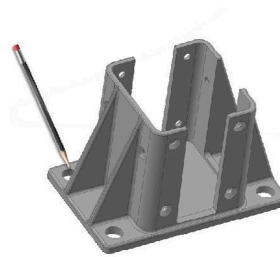
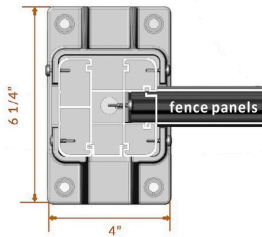

Mark Post Base Locations

- Measure and mark the location of each post base at 71" on center — meaning the center of one post to the center of the next should be exactly 71".
- It is recommended that 4" side of base run perpendicular to fence boards.
- Place post base over centre mark. With a pencil, mark the 4 outer holes.

Drilling Holes

- Using a hammer drill and 3/8" concrete drill bit, drill marked area at a 3.5" depth. You will want to mark your drill bit to ensure accurate depth.
- It is recommended to clear holes of debris using compressed air.

Attach Post Base

- Using an impact driver with a 9/16" socket, secure post base to concrete using supplied anchor bolts.

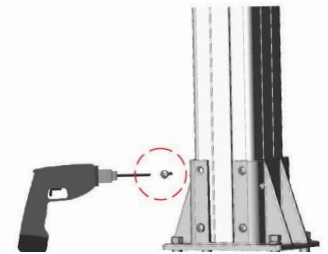

Set Posts in Place

- Insert one post (B) into each base. If cut, insert factory cut end into base.
- Ensure the open sides of the posts are facing the correct direction to accept the rails.
- Secure each post with 12 provided Attach Screws .

Install Bottom Rail

- Slide the bottom rail (from Step 1) into the channels of the two adjacent posts.
- Secure L-bracket to the inside of the post channel with a 6" Phillips drill bit and only the provided self-tapping screw. Do not overspin.
- The bottom rail should be installed 2.5" to 3.5" above the ground. This clearance helps prevent damage from seasonal ground movement.

STEP 3

FENCE PANEL INSTALLATION

Parts

- Fence Boards
- Side Spacers*
- Mid Spacers**

Tools

- Saw***

*Mid-trellis or open trellis panels

**Mid-trellis or open trellis WPC panels

***For panels less than 5.9'

Install Fence Boards

- Remove top rail if it was used for post alignment.
- Slide boards (A) into post channels.
- **WPC PANELS**
 - Privacy: Tongue of boards should face up.
 - Mid Trellis: Tongue of large boards should face down.
- **MID TRELLIS + OPEN TRELLIS (Fig 1)**
 - Between all or selected boards, slide or click Side Spacer (I) on either side of fence board.
 - WPC PANELS: Add 2 Mid Spacers (G) between applicable boards (Fig 2)

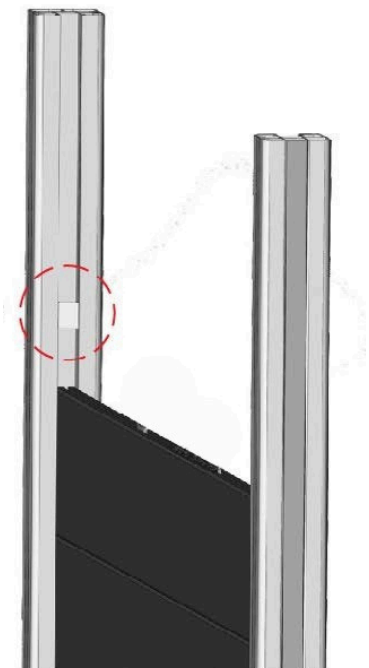

Figure 1

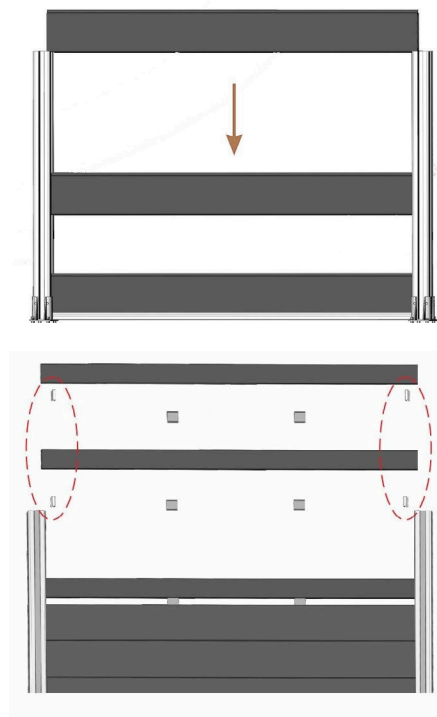

Figure 2

STEP 4

TOP RAIL INSTALLATION

Parts

Top Rail (from Step 1)
Self Tapping Screws

Tools

Drill
Phillips Bit
Saw

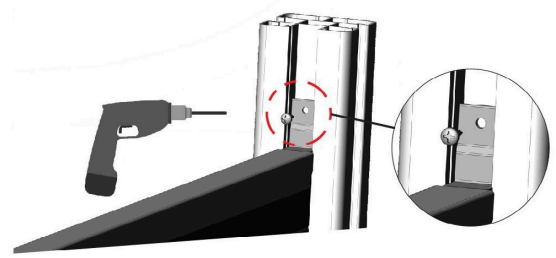

Top Rail

- Slide top rail in channels of posts and over last fence board.
- Using slight downward pressure, secure with supplied self tapping screws.

Trim Post

- Using a string line as a guide, cut excess height of post if needed.

STEP 5

POST SIDE COVER + CAP INSTALLATION

Parts

Post Side Cover
Post Cap

Tools

Mallet
Saw

Side Cover

- Slide or snap Post Side Cover (E) over open sides of post. Side cover will be longer than post. If short, join factory cut edges of another side cover to achieve full coverage.
- Measure and cut excess and use for inside top and bottom of post.

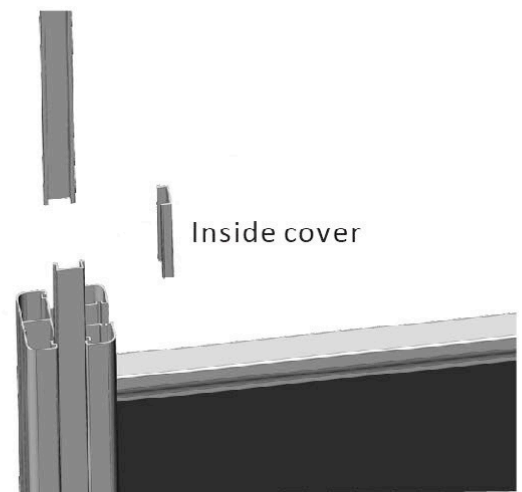

Post Cap

- Once all panels, rails and side covers are in place, install Post Cap (C). Tap with a mallet if needed.

WPC PANELS:

- With a bristled brush, scrub panels to remove a water soluble factory coating. Skipping this step may result in water stains after rain.
- Adjust sprinklers away from fence. Prolonged and repeated exposure to water may compromise board integrity and void warranty.